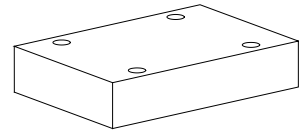

Blanking plate
Linking plate
 • $p_{max} = 350 \text{ bar}$

NG10
 ISO 4401-05

DESCRIPTION

Blanking and linking plates NG10 acc. to ISO 4401-05. The plates are zinc coated and will be supplied inclusive 5 O-rings ID 14,00x1,78 (article 160.2140).

APPLICATION

Blanking plates are used to seal all ports (P, A, B, T, T0) of a NG10 interface. With linking plates selected ports of a NG10 interface can be connected. Other ports not in use are sealed.

TYPE CODE

Blanking plate	A	BP	10	#	<input type="checkbox"/>
Linking plate	A	U	10 /	<input type="checkbox"/>	# <input type="checkbox"/>
Int. norme de raccordement ISO					
Blanking plate		BP			
Linking plate		U			
Nominal size 10					
Connection of ports see type code list and symbols					
Design-Index (Subject to change)					

DIMENSIONS

Blanking and linking plate

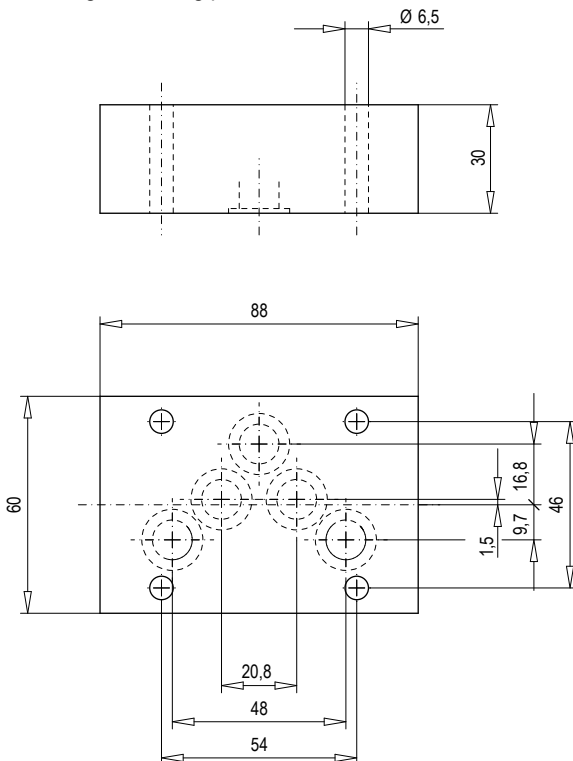
TYPES

Types	Article no.	Symbols
<i>Blanking plate:</i>		
ABP10	173.4150	 A P T B
<i>Linking plate:</i>		
AU10 / P-B / A-T	173.4250	 A P T B
AU10 / P-A / B-T	173.4251	 A P T B
AU10 / P-A	173.4252	 A P T B
AU10 / P-B	173.4253	 A P T B
AU10 / P-T	173.4254	 A P T B
AU10 / A-T	173.4255	 A P T B
AU10 / B-T	173.4256	 A P T B
AU10 / A-B-T	173.4260	 A P T B
AU10 / A-B	173.4257	 A P T B
AU10 / P-A-B	173.4258	 A P T B