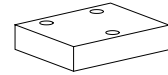

Blanking plate
Linking plate
 • $p_{max} = 350 \text{ bar}$
NG3-Mini[®]

DESCRIPTION

Blanking and linking plates NG3-Mini acc. to Wandfluh standard. The plates are phosphated and will be supplied inclusive 5 O-rings ID 4,50x1,50 (article 160.2045).

APPLICATION

Blanking plates are used to seal all ports (P, A, B, T, T_o) of a NG3-Mini interface. With linking plates selected ports of a NG3-Mini interface can be connected. Other ports not in use are sealed.

TYPE CODE

Blanking plate	PB	F	A03	#	<input type="checkbox"/>
Linking plate	PU	F	A03	-	<input type="checkbox"/>
Blanking plate	PB				
Linking plate	PU				
Flange construction					
Mounting interface NG3-Mini					
Connection of ports see type code list and symbols					
Design-Index (Subject to change)					

DIMENSIONS

Blanking and linking plate

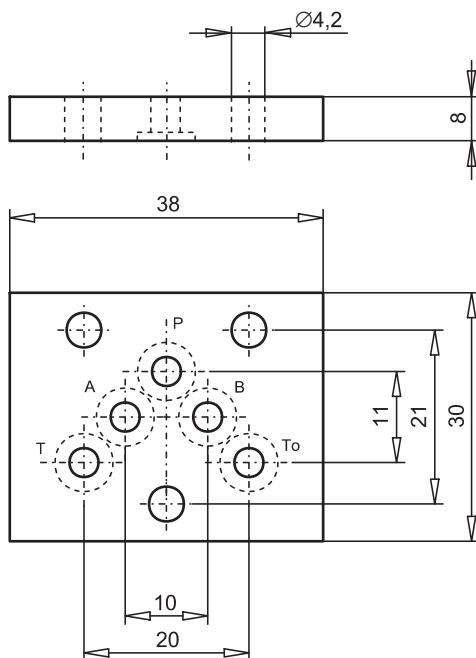
TYPES

Types	Article no.	Symbols
<i>Blanking plate:</i>		
PBFA03	173.0150	 A P T B
<i>Linking plate:</i>		
PUFA03 - P/B - A/T	173.0256	 A P T B
PUFA03 - P/A - B/T	173.0253	 A P T B
PUFA03 - P/A	173.0254	 A P T B
PUFA03 - P/B	173.0257	 A P T B
PUFA03 - P/T	173.0251	 A P T B
PUFA03 - A/T	173.0161	 A P T B
PUFA03 - B/T	173.0260	 A P T B
PUFA03 - A/B/T	173.0255	 A P T B
PUFA03 - A/B	173.0252	 A P T B
PUFA03 - P/A/B	173.0250	 A P T B