



**SCREW-IN CARTRIDGES INSTALLED**

The following screw-in cartridges are used in either the flange body or the sandwich body:

Type	Designation	Data sheet no.	Q <sub>max</sub> *
BVPPM22	pilot operated	2.3-529	20 l/min
BVPPM22**	pilot operated	2.3-530	20 l/min
BVIPM22	pilot operated, inverse	2.3-532	20 l/min
BVCPM22**	pilot operated, explosion proof EEx em	2.3-534	20 l/min
BVBPM22	pilot operated, explosion proof Ex d	2.3-536	20 l/min
BVBPM22**	pilot operated, explosion proof EEx d	2.3-535	20 l/min
BVVPM22	pilot operated, with integrated electronics	2.3-531	20 l/min
BDPPM22	direct operated	2.3-539	20 l/min
BDPPM22**	direct operated	2.3-540	20 l/min
BDIPM22	direct operated, inverse	2.3-542	20 l/min
BDCPM22**	direct operated, explosion proof EEx em	2.3-544	20 l/min
BDBPM22	direct operated, explosion proof Ex d	2.3-547	20 l/min
BDBPM22**	direct operated, explosion proof EEx d	2.3-545	20 l/min
BDVPM22	direct operated, with integrated electronics	2.3-541	20 l/min
BDWPM22	direct operated, inversé, with integrated electronics	2.3-543	20 l/min

\* Can deviate from the values on the data sheets of the screw-in cartridges.

\*\* Do not use anymore for new applications.

**GENERAL SPECIFICATIONS**

Description	Pilot and direct operated proportional pressure relief valve	
Nominal size	NG4-Mini according to Wandfluh <i>standard</i>	
Constructions	Flange or sandwich	
Operations	Proportional solenoid	
Mounting	3 fixing holes for socket head cap screws	
M5 or studs M5		
Connections	Threaded connection plates Multi-flange subplates Longitudinal stacking system	
Weight:	• Flange type	m = 1,15 kg
(without screw-in cartridge)	• Sandwich type P, A, B	m = 0,96 kg
	• Sandwich type AB	m = 1,24 kg

**REMARK!**

Detailed performance data and additional hydraulic and electric specifications may be drawn from the data sheets of the corresponding installed screw-in cartridge.

**CAUTION!**

 The performance data especially the „**pressure-flow-characteristic**„ on the data sheets of the screw-in cartridges refer to the screw-in cartridges only. The additional pressure drop of the flange body respectively sandwich body must be taken into consideration.

**DIMENSIONS**

Flange construction

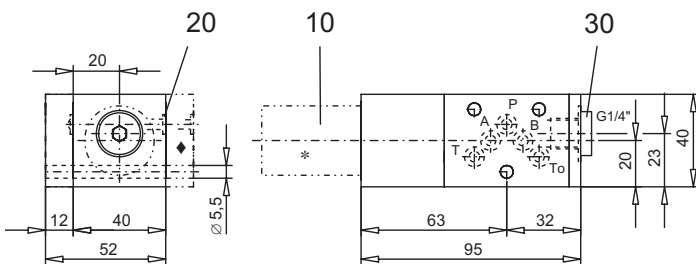

Sandwich construction in A, B or AB

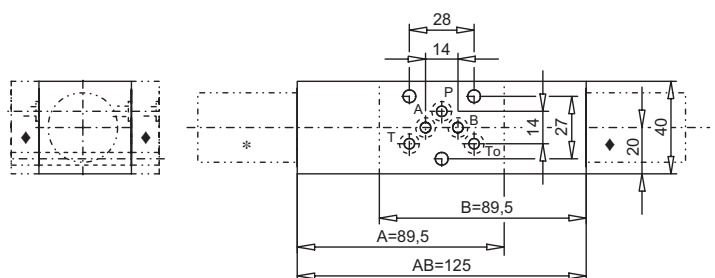

Sandwich construction in P

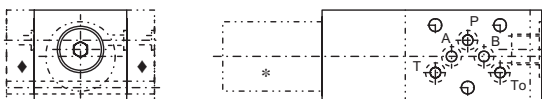

\* The envelop dimensions of the screw-in cartridge are shown on their corresponding data sheets.

♦ Distance plate BDP4/... must be ordered separately.

**PARTS LIST**

Position	Article	Description
10	609.3 ...	Screw-in cartridge
20	160.2052	O-ring ID 5,28x1,78
30	238.2406	Plug VSTI G1/4"-ED (only flange and sandwich type in P)

**ACCESSORIES**

Proportional amplifier	register 1.13
Distance plate BDP4/12 (12 mm)	art. no. 173.1450
Distance plate BDP4/20 (20 mm)	art. no. 173.1451
Distance plate BDP4/30 (30 mm)	art. no. 173.1452

Technical explanation see data sheet 1.0-100