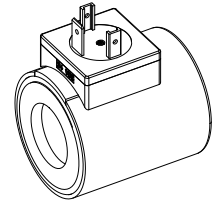

**Solenoid coil W.E45/23 x 50
 in accordance with DIN VDE 0580
 Protection class IP 65/67/69K**

DESCRIPTION

The slip-on solenoid coil W.E45/23x50 is available in three different connection versions (see type code). The design corresponds to the DIN VDE standard 0580. The housing is made of steel (nickel-chromium coated), the connector socket is made of plastic material.

FUNCTION

With the combination of an armature tube the function of a switching solenoid or of a proportional solenoid results. The solenoid coils are available with the standard nominal voltages 12 VDC and 24 VDC.

APPLICATION

The solenoid coils are mainly utilised in hydraulic applications.

TYPE CODE

Metal housing, round Connection version: Connector socket EN 175301-803/ISO 4400 Connector socket AMP Junior-Timer Connector Deutsch DT04-2P Coil type Internal coil diameter 23 mm Coil clamping length 50 mm Standard-nominal voltage U_N	<input type="checkbox"/> D <input type="checkbox"/> J <input type="checkbox"/> G	W <input type="checkbox"/> E45 / 23 x 50 - <input type="checkbox"/> # <input type="checkbox"/> 12 VDC <input type="checkbox"/> G12 24 VDC <input type="checkbox"/> G24 115 VAC <input type="checkbox"/> R115 230 VAC <input type="checkbox"/> R230	
Design-Index (Subject to change)			

SPECIFICATIONS

Coil winding insulation class H (180 °C)
 Relative duty factor 100 % DF/ED
 combined with armature tube and valve
 Ambient temperature -20...+70 °C
 Corrosion protection Salt spray test according to EN ISO 9227:≥ 200 h

		12 VDC	24 VDC	115 VAC	230 VAC
Nominal power (20 °C) (W)	(W)	30,5	32,5	28	30
Limiting current (50 °C) (A)	(A)	1,69	0,88	–	–
Limiting power (50 °C) (W)	(W)	20,3	21,1	–	–
Nominal resistance (20 °C) (Ω)	(Ω)	4,73	16,9	385	1425
Number of windings (–)	(–)	620	1250	5350	10700
Weight of solenoid coil (kg)	(kg)	0,33	0,33	0,33	0,33

SAFE OPERATION

Caution: Because of the danger of over-heating the solenoid coil must only be commissioned together with an armature tube as well as with a valve.

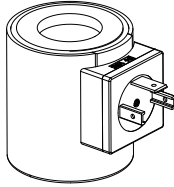
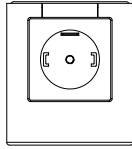
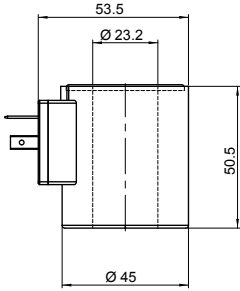

- Execution: W **D** E45/23x50
- 3-poles 2 P+E
 - Protection class IP 65
- With corresponding mating connector and professional assembly.

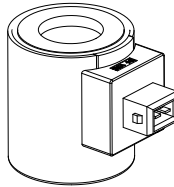
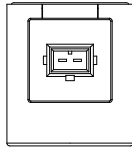
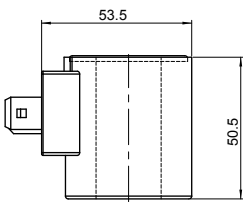

- Execution: W **J** E45/23x50
- 2-poles 2P
 - only for $U_N \leq 75$ VDC
 - Protection class IP 66
- With corresponding mating connector and professional assembly.

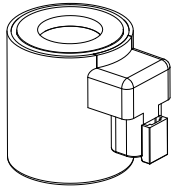
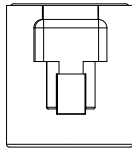
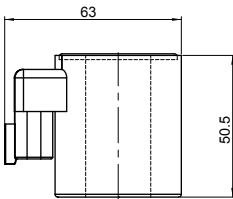

- Execution: W **G** E45/23x50
- 2-poles 2P
 - only for $U_N \leq 75$ VDC
 - Protection class IP 67 and 69 K
- With corresponding mating connector and professional assembly.

Technical explanation see data sheet 1.1-400 and 1.1-410